

*Have Your
Say*

**Landsborough Placemaking
Draft Master Plan
&
Cribb Street
Streetscape Project**

**Community Information Session
Presentation Materials
March-April 2019**

Draft Master Plan

About the Draft Master Plan

The Landsborough Placemaking Master Plan is a blueprint created by the community and facilitated by Council to realise a shared vision for Landsborough's future, with a focus on the town's public realm.

What it includes

- Strategic direction and guidance for streets and open space in the study area
- A framework to guide community led activation in the public realm
- Identification of potential future project opportunities that are subject to further planning, partnerships and potential funding sources from government, the private sector and the community
- Priorities for council's Capital Works Streetscape Program: \$3.3M includes project management, design and construction. Streetscape planned to be delivered 2020 (subject to council's budget approval process).

What it does not include

- Does not guide development of the private realm or private properties
- Does not promise that all issues will be solved.

Other considerations

- Parkland space on eastern side of Cribb Street is State Government (Queensland Rail) owned land
- A number of council owned land areas and community assets are subject to potential impacts from the State Government B2N (Beerburrum to Nambour) rail project. This includes the former council depot site on Stephens Street.

1

Background Research & Site Analysis

Dec 2017

2

Community Engagement 1 - 'Values & Visioning'

Jan 2018 - Feb 2018

3

Draft Master Plan Development

Mar 2018 - Feb 2019

4

Community Engagement 2 - 'Testing the Plan'

Mar 2019

'Have we got it right?'

- Landsborough Draft Master Plan
- Early ideas for Cribb Street Streetscape Project

5

Finalising the Draft Master Plan Report

Aug 2019

6

Community Engagement 3 - 'Presenting your Placemaking Master Plan'

Late 2019

What is Placemaking?

Placemaking is an integrated approach to engaging and collaborating with communities to create meaningful and activated places that reflect their values.

Draft Master Plan

Landsborough Then, Now and into the Future

Landsborough has a rich heritage story that contributes to the place that it is today... and will continue to be celebrated and reflected in its future...

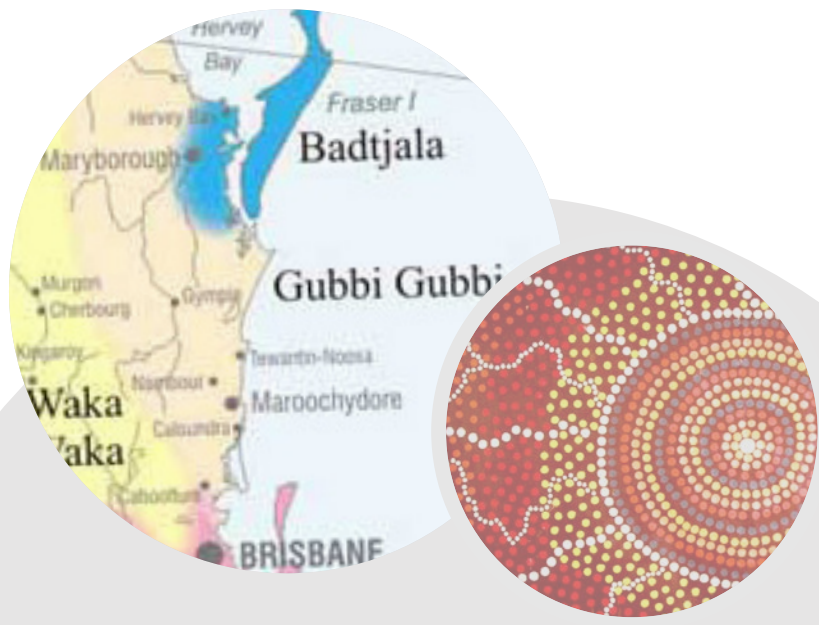

Indigenous Heritage

A Cultural Landscape Study identified numerous occupation sites within the Glass House Mountains area, including women's birthing sites, and grinding grooves at Rocky Creek (southwest of Landsborough). These sites are connected by traditional pathways indicative of intensive and long occupation of this area by Aboriginal people.



Local Place

- Landsborough is a local activity centre providing goods and services to Landsborough and surrounding communities.
- Landsborough has a resident population of 4,381 with 35 to 39s as the largest age group. There has been a 31% increase in couples without children since the last census.

Gateway

- Landsborough is a physical gateway site that connects the coast and the hinterland

Commuter Hub

- Landsborough is the largest Sunshine Coast commuter hub servicing both local commuters from the coast and the Blackall Range, and connects Brisbane to the Maroochydhore.

Destination

- Landsborough town centre is identified as one of Queensland's Great Places (SEQ Regional Plan 2017).
- Landsborough is a picturesque and historic hinterland town. The town includes a number of heritage places including Landsborough Museum.
- Landsborough is located in close proximity to key regional tourism attractions including Australia Zoo; and is situated close to significant outdoor recreation and cultural heritage sites such as Ewen Maddock Dam, Dulchara National Park and Mellum Creek.

1871

Mellum Creek

In 1871 the township was named Mellum Creek, with Mellum thought to be from an Aboriginal word meaning 'volcano'.

1877

Industry

Timber cutters harvesting red cedar, beech, hoop and bunya pine from the Blackall Range brought activity to the township. Isaac Burgess built the first hotel, store and butchers shop.



Rail Line

The opening of the rail line between Caboolture and Yandina reinforced the value of the town as a staging point to the North Coast. The township was renamed to Landsborough after William Landsborough.

1912

Local Government

Shire of Landsborough was established as the administrative centre of local government (later in 1987 the Council Chambers were relocated to Caloundra as City of Caloundra).

2008

Former City of Caloundra undertook the Landsborough Art, Community & Heritage Precinct Master Planning Project.

2016

Census
Landsborough population just over 4000.



Stories of Landsborough

A documentary has been produced by SCC seeking to capture oral histories of the town. These stories will be used to inform future placemaking initiatives.

Local Context



Regional Setting

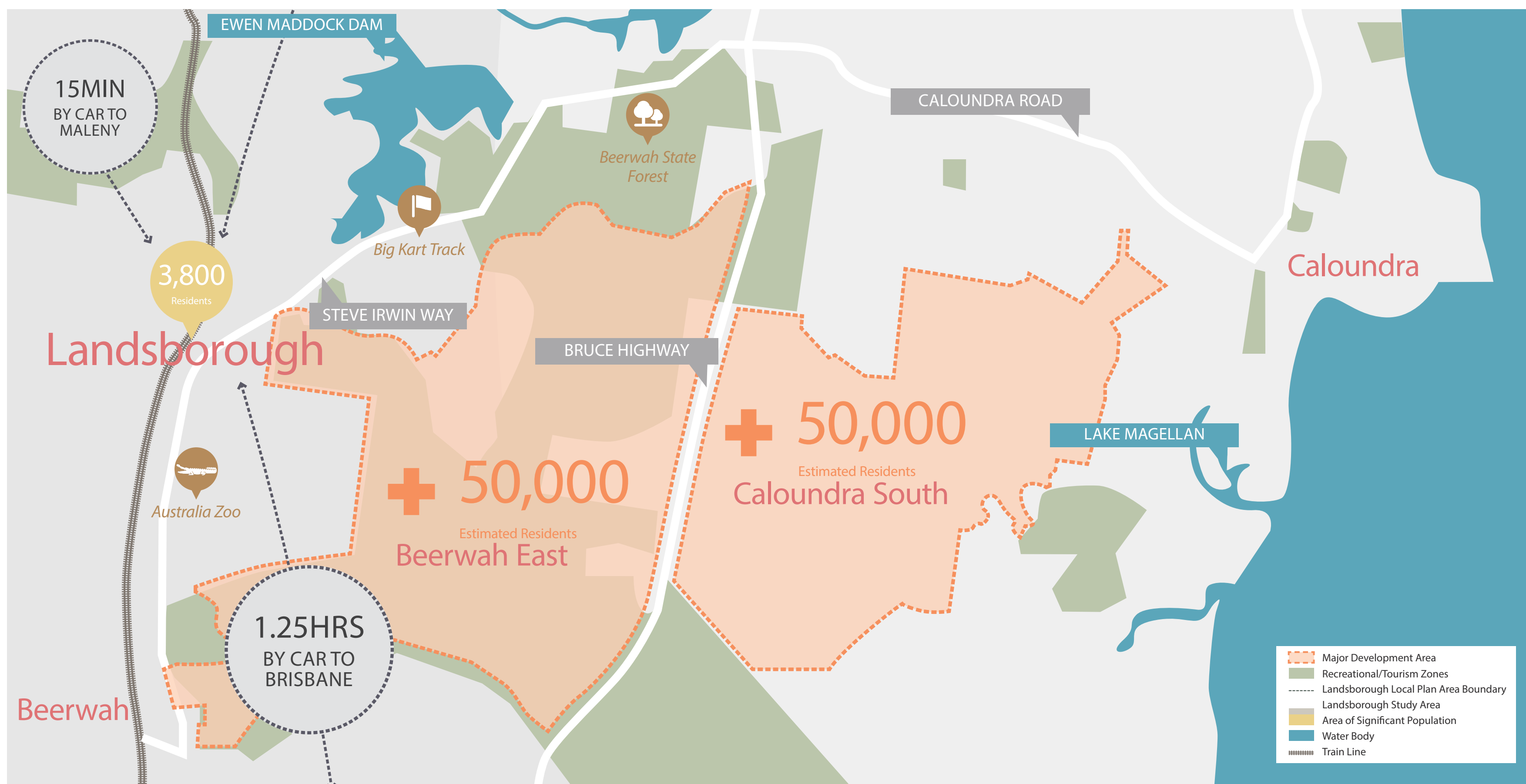

Landsborough is at the heart of a changing region. Council recognises the opportunity to understand what is valued about Landsborough today, and strengthen it for the future.

Draft Master Plan

Community Engagement



What we have heard so far...

We asked the community the below questions... This summary shows themes of the most frequent responses.



526
people have taken part
Stage 1 engagement early 2018

How you describe Landsborough today?



- Top Response
- 1 Quiet
 - 2 Heritage
 - 3 Friendly / Welcoming
 - 4 Country town feel
 - 5 Quaint / Cute
 - 6 Boring / Inactive
 - 7 Tired
 - 8 Commuter hub / Railway station
 - 9 Gateway
 - 10 Relaxed

What do you love about Landsborough?

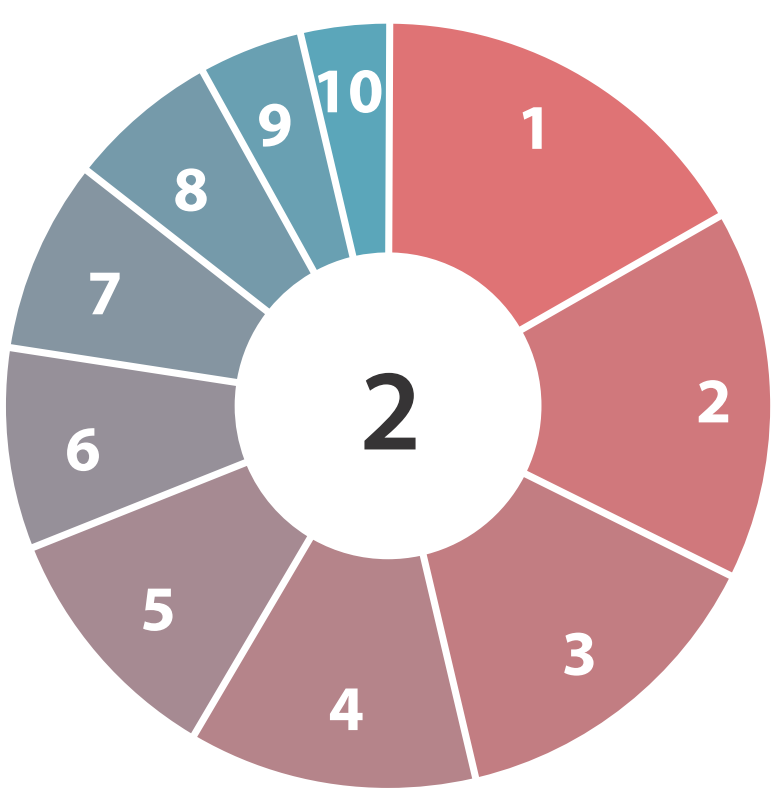

- Top Response
- 1 Community atmosphere
 - 2 Quiet / Relaxed
 - 3 Central location / Gateway
 - 4 Country town feel
 - 5 Heritage
 - 6 Small town feel
 - 7 Public transport
 - 8 Parks / Green spaces
 - 9 Trees
 - 10 Access to recreation places

What is missing/would you change?



- Top Response
- 1 Railway intersection
 - 2 Beautify town centre
 - 3 Diverse / Vibrant shops
 - 4 Parking
 - 5 Improved pedestrian links
 - 6 Traffic improvements
 - 7 More cafes / Restaurants
 - 8 Parks / Green spaces
 - 9 Town centre
 - 10 Activities / Points of interest

What would you keep the same in Landsborough?

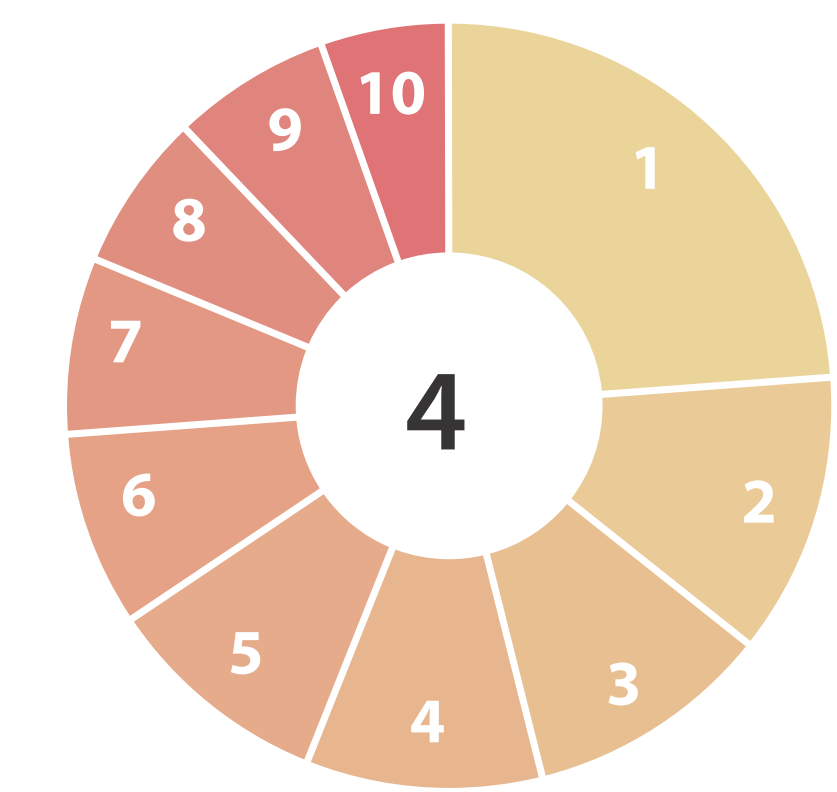

- Top Response
- 1 Heritage
 - 2 Small town feel
 - 3 Country atmosphere
 - 4 Local independent businesses
 - 5 Community
 - 6 Green spaces
 - 7 Trees
 - 8 Keep everything
 - 9 Large house blocks
 - 10 Public transport access

What is your future vision for Landsborough?



- Top Response
- 1 Activation / Markets
 - 2 Beautify town centre
 - 3 Central community space
 - 4 Cafes / Restaurants / Shops
 - 5 Country character
 - 6 Heritage
 - 7 Traffic improvements
 - 8 Commuter hub
 - 9 Parks / Green spaces
 - 10 Pedestrian linkages

Have we heard you right?

Draft Community Vision Elements

The Draft Community Vision Elements reflect a summary of community desires for Landsborough in the future.

Landsborough will be a place that....



A Place for People

- Is easy to get around, with improved traffic movement, pedestrian access & parking
- Provides essential amenities such as toilets and water bubbler in public spaces
- Is safe and enjoyable to spend time day or night



A beautiful & defined town centre

- Is a local place that appeals to residents and visitors alike
- Has a multi-use central community gathering space
- Has an attractive and appealing town centre
- Has an appealing entrance to the town and is a clear gateway to the region



An authentic character & identity

- Has a distinct identity authentic to Landsborough
- Celebrates its heritage and location in 'Glass House Country'
- Retains a country town look and feel
- Has a strong sense of greenery and nature



A reason to visit & stay

- Has a variety of spaces to enjoy and explore
- Has a sense of atmosphere, activity and regular events
- Has a lively, attractive shopping area and eating experience
- Has a range of independent and local shops

Draft Master Plan

Vision & Principles

Draft Public Realm Vision

Landsborough continues to evolve into a vibrant, well-connected and creative community. Drawing on its past, to enrich its future; it will be a place for today's lifestyles with a village atmosphere.

Diverse public spaces are sensitively designed and layer social, cultural and recreational uses, as well as activities — to create memorable experiences that sustain Landsborough as a locally loved destination.

Distinctively relaxed and accessible, Landsborough balances its rural urban character, with a strong connection to nature and never loses its sense of being in Glass House Country.

Guiding Principles

Design principles assist in translating the vision so that community desires are reflected in any future planning and projects.



Activate + Innovate

- Integrate flexible and diverse community spaces
- Maximise all access options and prioritise pedestrians
- Activate the town heart
- Design spaces for activation
- Encourage people to shape places (placemaking)



Connect + Explore

- Introduce safe, legible, accessible and attractive links
- Create a sense of welcome and arrival
- Leverage connections to surrounding world-class recreation assets
- Add further spaces and places to explore
- Enhance transport connections and links to parking



Enhance + Enrich

- Enrich places authentically
- Reflect Landsborough's heritage and rural town character
- Celebrate Indigenous cultural connections
- Preserve significant remnant vegetation
- Embed environmental sustainability

Key Placemaking Opportunity Areas

The Placemaking Opportunity Areas provide defined locations to concentrate positive change and guide future projects, interventions and initiatives such as the creation of new public spaces, access and movement improvements, and community activation.

The Borough will function as the working hub of the village — home to many small businesses who offer services and goods to the town. During special events, the agile reuse of existing carpark, easement, laneways, and servicing areas temporarily transform to host community events and pop-up business-led activations.

The Arts and Heritage Precinct becomes a focal point for community learning, creativity and celebration and embraces Landsborough’s rural flavour. Cultural and community facilities are connected by walkways and public spaces set within an interesting landscape which integrates public art and heritage elements. Connections to adjacent open space and walking tracks are easy to find and inviting.

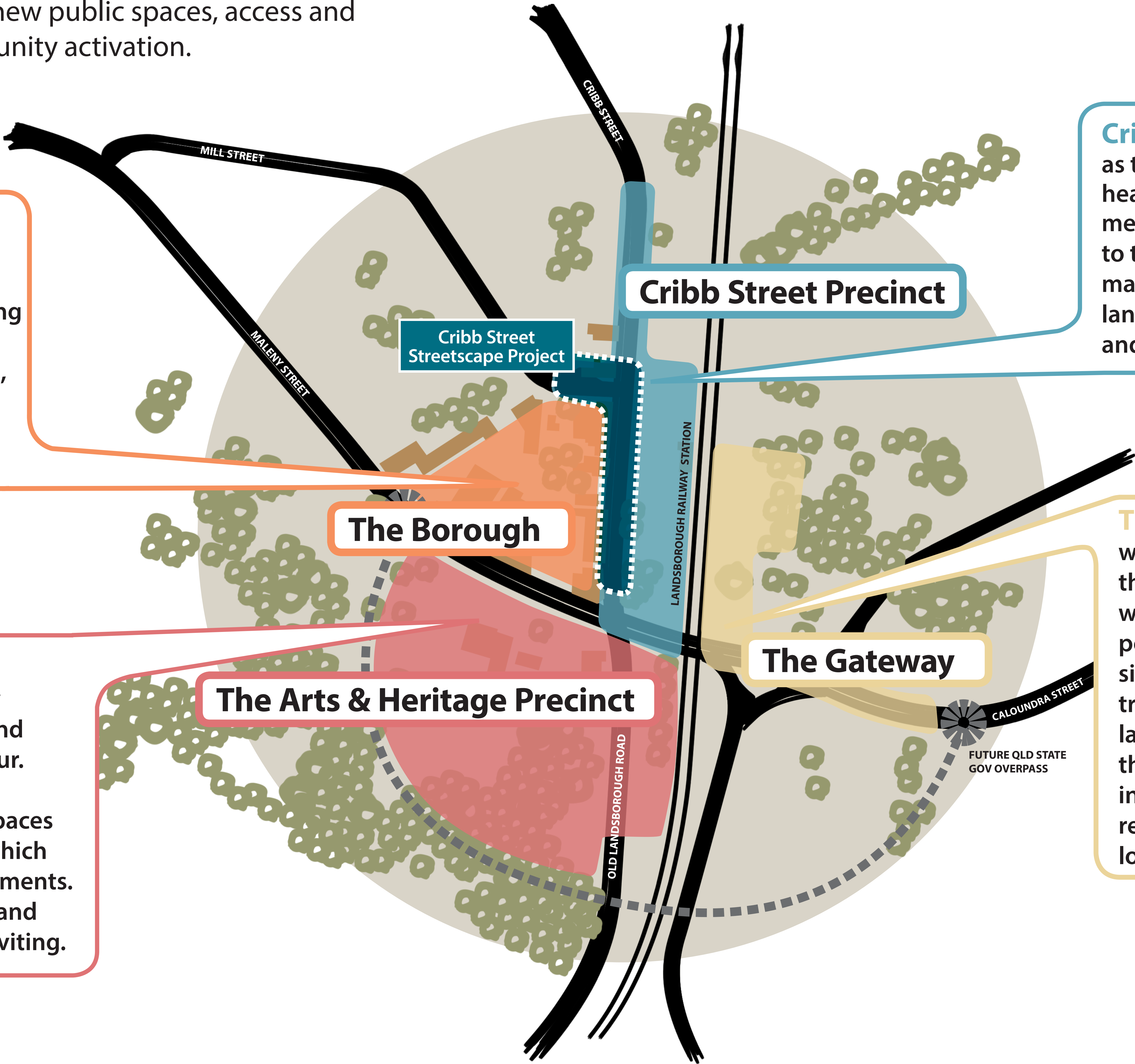

Cribb Street Precinct will evolve as the physical and symbolic 'village heart' of Landsborough — a place to meet, eat, shop and connect. Central to the precinct is the established main street (Cribb Street), connecting laneways, and adjacent rail station and public park area.

The Gateway will serve as a welcome to the town, capturing the essence of Landsborough and what it offers as one of its key arrival points. Located on the eastern side of the town, feature street trees frame character homes, and landscaping features reference the town’s identity providing an inviting backdrop to the businesses, recreational and transit amenity located here.

Draft Master Plan

Strategies

Strategies provide guidance to coordinate future changes in Landsborough and are based on what we know about the place today and desired improvements identified from the draft future vision for the town. Ideas for the future are subject to further planning, partnerships and funding sources.

A place for people

What we know today...

- The town lacks a central focus and is disjointed for pedestrians
- Inadequate public space for people to gather and connect in the town centre
- Pedestrian linkages insufficient, not legible and informal crossing points across roads, laneways and private car parks conflict with vehicles
- Landsborough is a key commuter hub as such requires better integration of the transit hub with the town centre and future open spaces to ensure that accessible and legible active transport connections are developed
- Vehicles dominate the townscape as a result of long term parking for the train station, commercial precinct parking and overflow parking into surrounding road verges.

Some ideas for the future...

- Introduce pedestrian crossings across Cribb Street and investigate a crossing on Maleny Street to improve pedestrian connectivity and permeability
- Recommend an intersection study and investigation of the Cribb Street/ Maleny Street junction to improve traffic flow and reduce congestion
- Recommend a parking study be undertaken and strategy developed to guide improvements of parking in the town centre
- Introduce a welcome treatment at main points of arrival to the town, supported by wayfinding signage throughout the town centre
- Ensure that enhancements to the public realm provide safe and secure places that reflect Crime Prevention Through Environmental Design (CPTED) principles including enhanced lighting

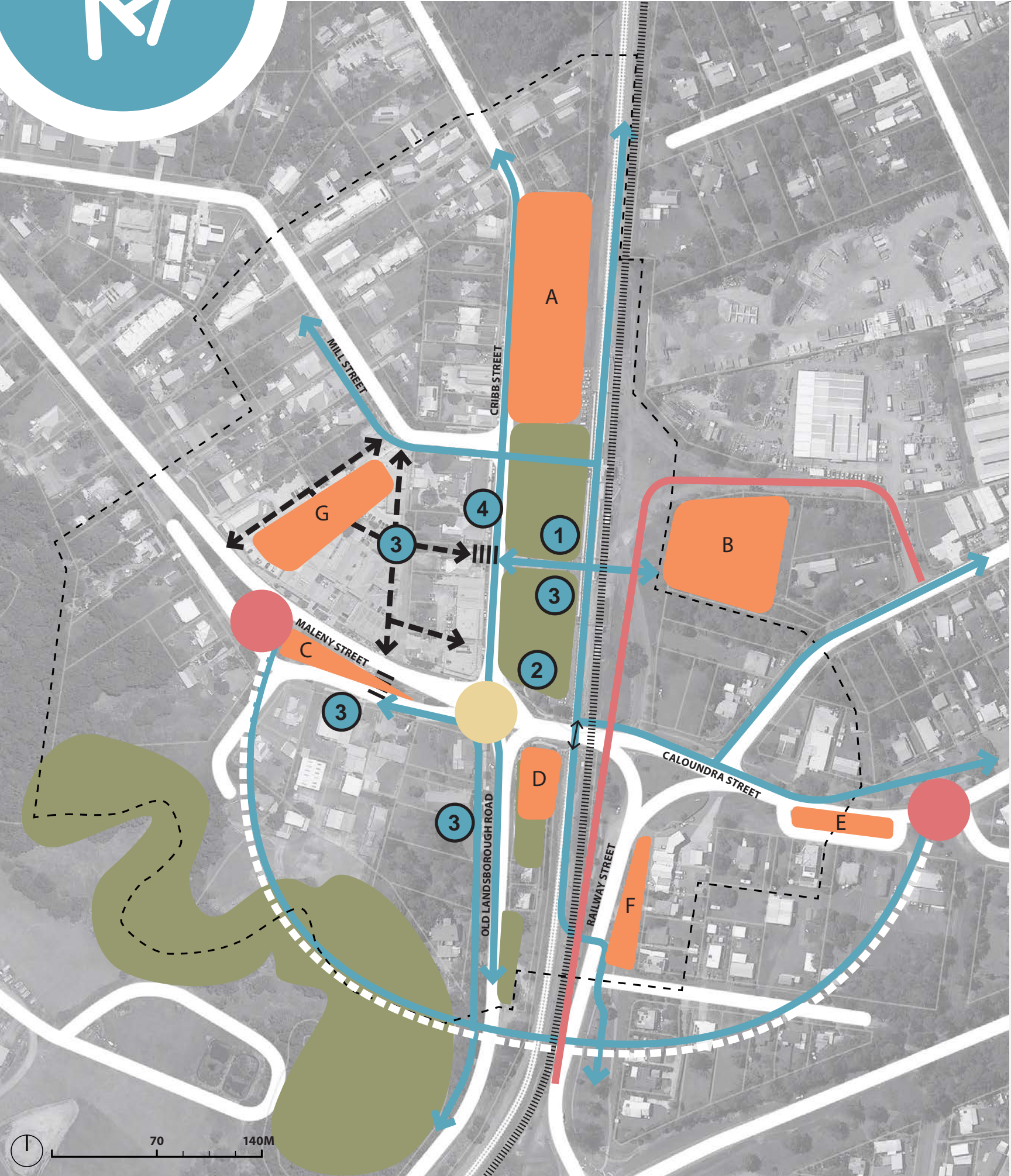

- Open Space Network
- Public Toilets, End Of Trip Facilities, Bicycle Racks
- Public Toilets
- Wayfinding Signage
- Cribb St Streetscaping
- Potential Formal Pedestrian Crossings
- Potential Pedestrian Crossing Facilities
- Potential Informal Future Pedestrian Through-Block Connection
- Pedestrian / Cycle Linkage
- Proposed State Government Future Overpass
- Proposed State Government Rail Duplication
- Proposed State Government Intersection Upgrades
- Recommend investigation of Cribb St / Maleny St Junction
- Potential Railway St Realignment For Access to New Bus Interchange & Parking
- Proposed State Government Reconfigured Carpark
- Proposed State Government 'Park & Ride' Facility
- Museum Site Carpark & Potential Flexible Event Space
- Old Landsborough Rd Public Carpark Investigate Provision For Caravans & Motorhomes
- Caloundra St Carpark
- Railway St Carpark
- Proposed Retail Precinct Central Carpark

An Authentic 'Landsborough' image & identity

What we know today...

- Landsborough has an important historic story to tell of early settlement, rural village life, regional transportation and early Queensland architecture
- Landsborough has an informal open space character with a high level of landscape amenity consisting of significant remnant vegetation and established formal character plantings
- Landsborough has an established indigenous heritage as 'A Place of Meeting' making this an authentic point of difference for further development.
- Currently the place does not articulate the town's desired image and identity.

Some ideas for the future...

- Establish an open space network that is flexible and adaptable, that enhances local landscape character
- Preserve and enhance significant remnant vegetation to reinforce natural character and provide a green frame around built form to connect people with nature
- Investigate the development and promotion of a heritage interpretative trails program (building on existing programs)
- Enhance existing street planting with additional shade trees within road verges and introduce landmark plantings at the town's gateway to create a strong sense of identity for the town
- Encourage the introduction of green walls (vine plantings) in potential laneway connections to further add to the town's sense of nature
- Introduce feature lighting, catenary lighting and fairy lights to bring the town to life after dark.



- Retained Significant Character Revegetation Areas
- Green Link Street & Laneway Planting
- Shaded Open Space Planting
- Shaded Carpark Planting
- Screen Planting to Proposed QR / TMR Infrastructure
- Landmark Planting at Town Arrival Zones
- Local Heritage Opportunity (Potential Heritage Walk / Smart Phone Apps)
- Integrated Public Art Opportunities

Beautify & define the town core

What we know today...

- Internal visual connections within the town are dominated by views to railway infrastructure, car parks which detract from existing traditional built form, heritage elements, and streetscape
- Inconsistent building facades and excessive advertising signage along Cribb Street dulls street character
- The town's identity isn't enhanced or reinforced by the public realm

Some ideas for the future...

- Establish a town heart by strengthening and beautifying Cribb Street
- Investigate options to enhance park fronting Cribb St. and land freed by potential future rail level crossing site (currently owned by State Government), to establish a place of welcome at the heart of the town
- Investigate delivery of a local and/or district scale park within the central town area
- Encourage business-led improvement of private car parking, forecourt and laneway areas in Cribb St & Borough precinct
- Introduce outdoor dining space areas along Cribb Street.
- Enhance streetscaping and signage elements on the eastern side of the town to improve the experience and reinforce identity of the town



- Open Space Network
- Potential Revitalisation Opportunity
- Primary active street frontages as per Local Area Plan 2014
- Potential Community Space / Visitor Information Kiosk
- Potential Community Hub
- Investigate Play Space / Childrens Garden
- Investigate Space for Pop-up Activation
- Investigate Catenary lighting and temporary structures to laneways
- Adaptive reuse of Council Chambers, School of Arts Hall, Old General Hall
- Investigate Potential 'Landsborough Green' Plaza Space
- Potential Pedestrian Laneway Connection

A reason to visit & stay

What we know today...

- Many people currently travel through Landsborough but do not spend time in the town. This will be further challenged with the proposed TMR overpass project which is likely to direct traffic around the town.
- The town lacks strong reason to visit and a diversity of spaces and points of interest to encourage people to stay and explore

Some ideas for the future...

- Reinvigorate the town as a destination by incorporating public spaces that enable community and business-led activation
- Introduce flexible spaces to encourage a range of activities and events
- Enhance the Landsborough Museum precinct by improving car parking and support the adaption of public space for events
- Further investigate development of the Heritage and Arts precinct as a major attractor and point of difference for the town
- Investigate options for a central play space to encourage families to stay longer
- Investigate the potential for a kiosk or community pavilion to act as a hub for activities and initiatives to support the visitor experience
- Establish a public wifi network in key areas to encourage use of public spaces and access to visitor information
- Develop cross-promotion of what is on offer with Glass House Country and Sunshine Coast tourism strategies

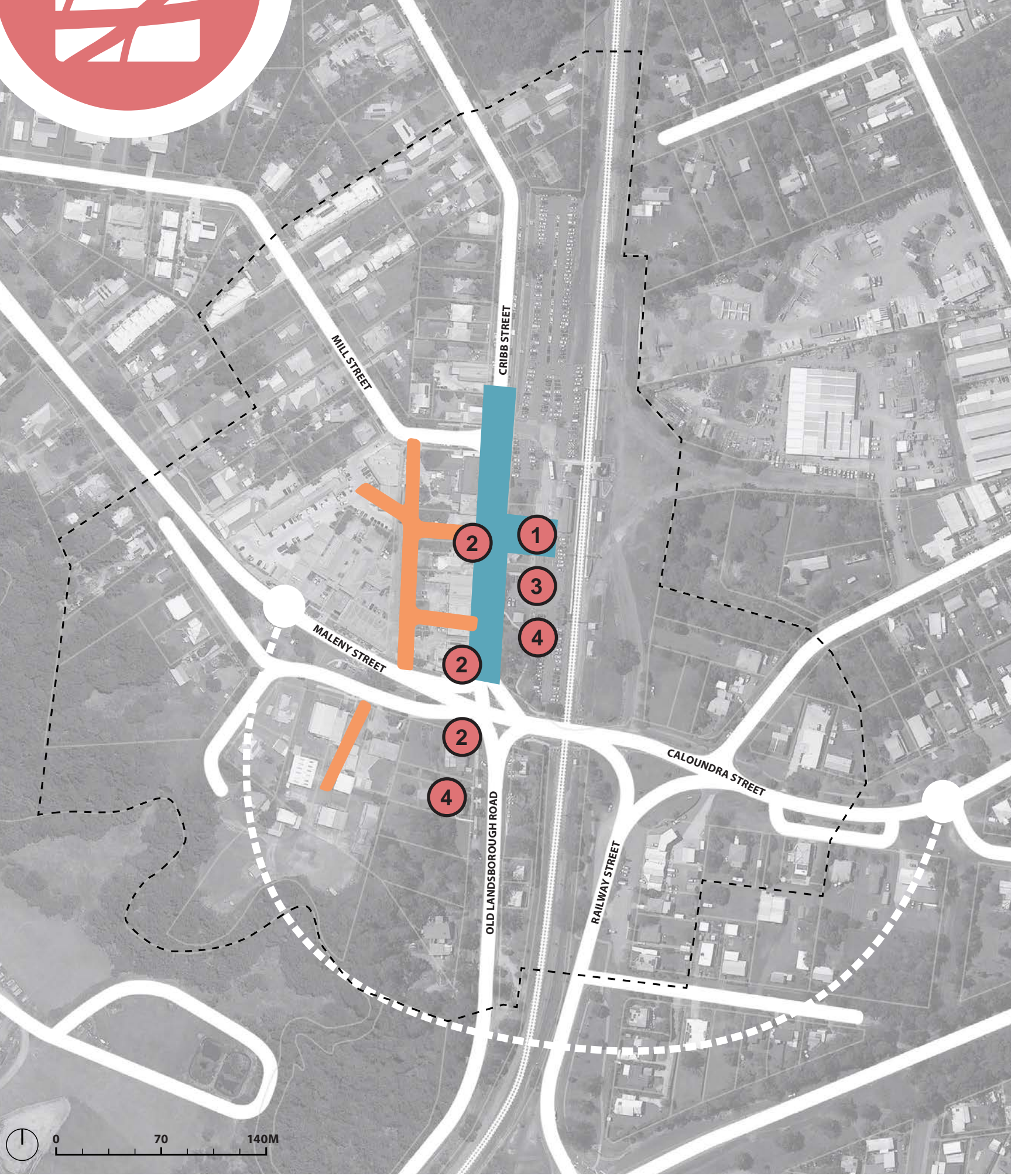

- Investigate Potential Town Heart Community Space
- Integrated Public Art Opportunities
- Investigate Community Pavilion / Kiosk
- Flexible Community Spaces for Events (pop up events, live music)
- Cribb St streetscape enhancements to create a strong community focal point
- Investigate and Support Laneway Activation

Further engagement

Ways you can be involved going forward...

We want you to be a major partner in shaping Landsborough's future not only the visioning stage, but in the implementation and on-going development and activation of Landsborough...

1

Cribb Street

Be part of the evolution of Cribb Street by joining the Streetscape Reference Group. As a member of this group you can participate in meetings and workshops to support streetscape infrastructure improvements.

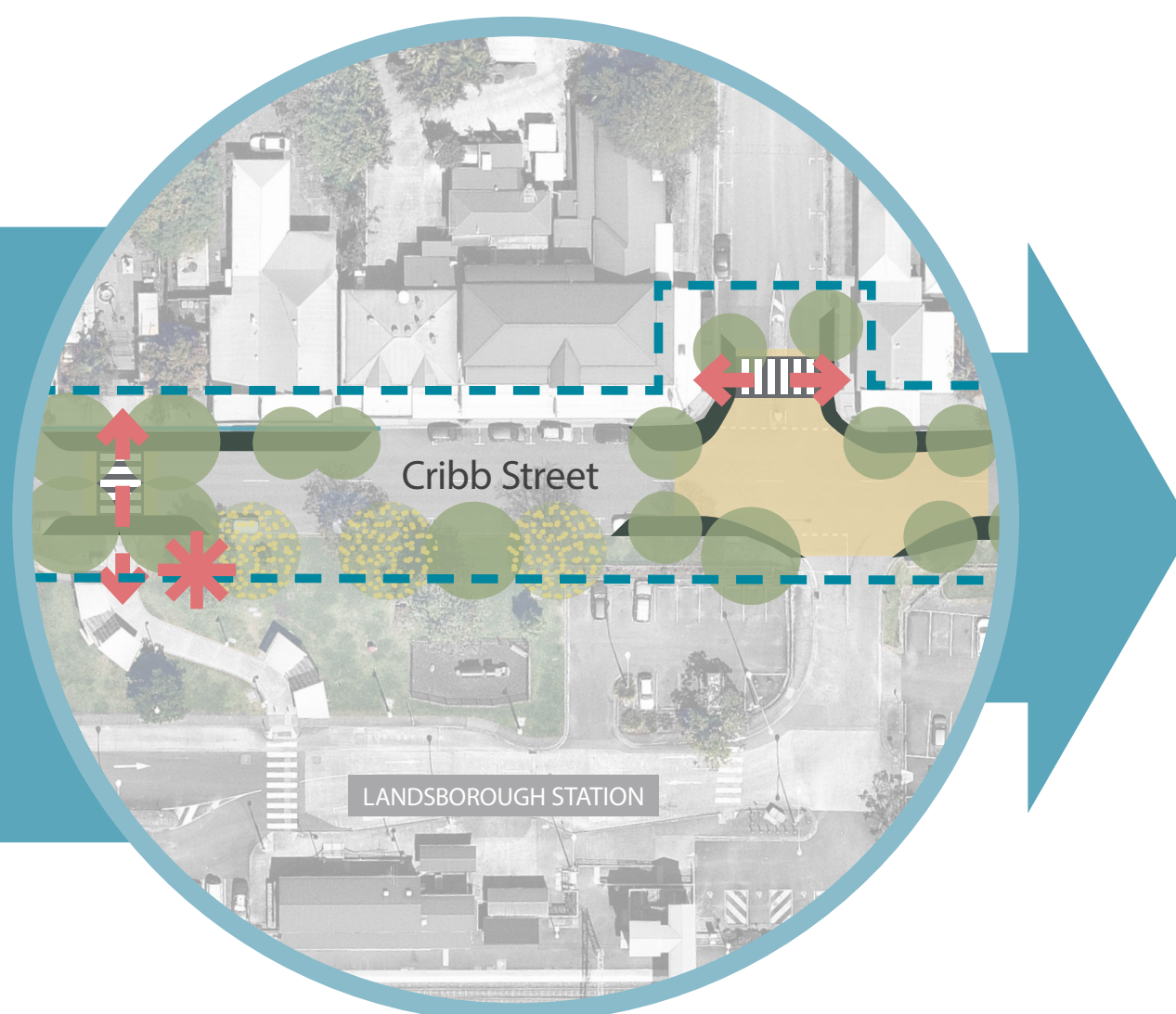

Register today...

Use the survey provided to register your interest for ongoing involvement



2

Activate Landsborough

Be part of an engaged community group focused on developing activities, events and local initiatives to activate Landsborough.



Final Placemaking Master Plan

Later this year council will present the final Landsborough Placemaking Master Plan. Keep informed and have your say via the council website.

<https://haveyoursay.sunshinecoast.qld.gov.au>

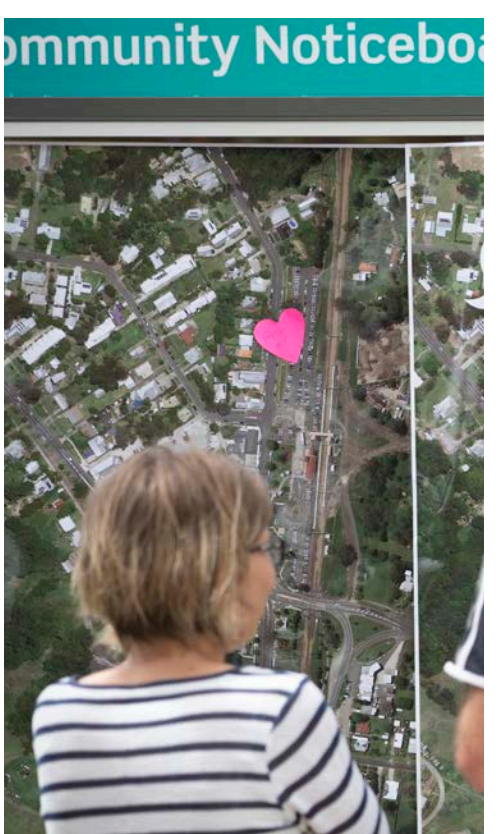
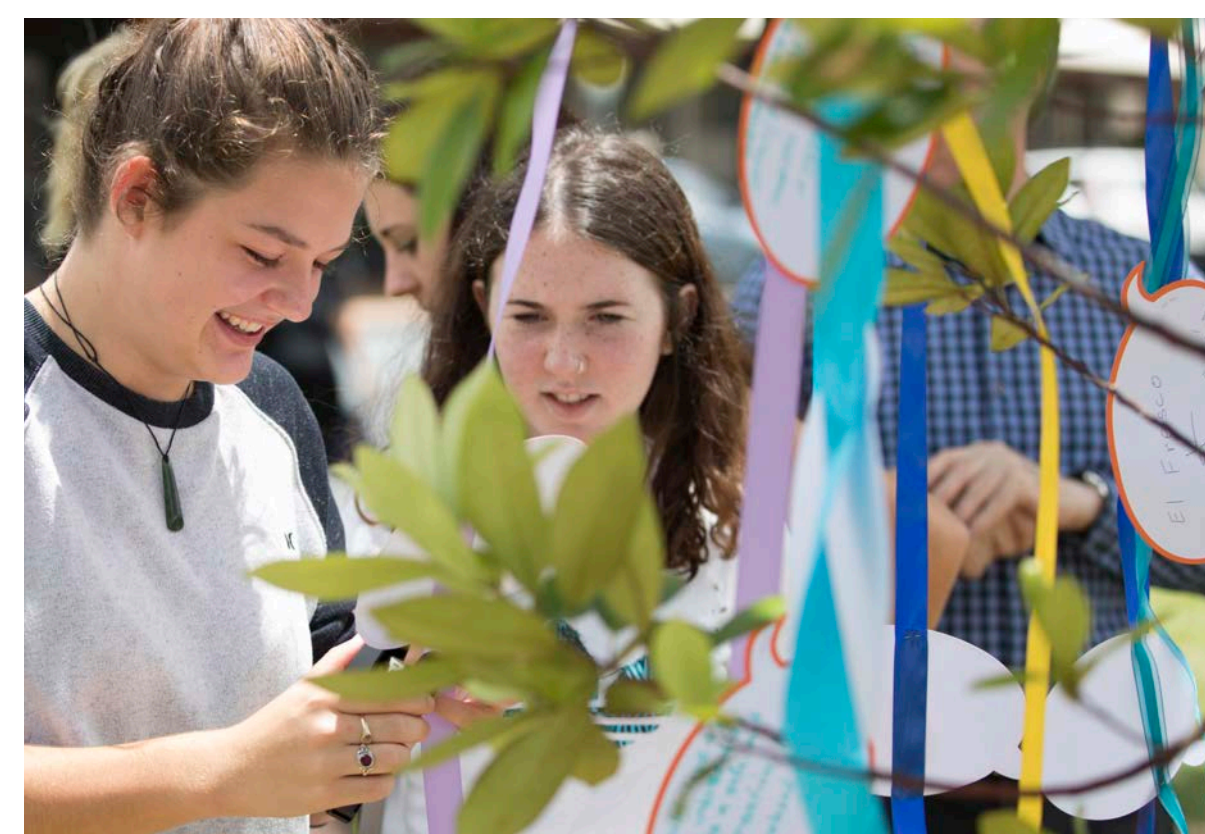

Cribb Street Streetscape Project

Council have planned streetscaping works in Landsborough as part of it's Capital Works Program.

Community feedback received to date identifies Cribb Street as a priority placemaking area for Landsborough.

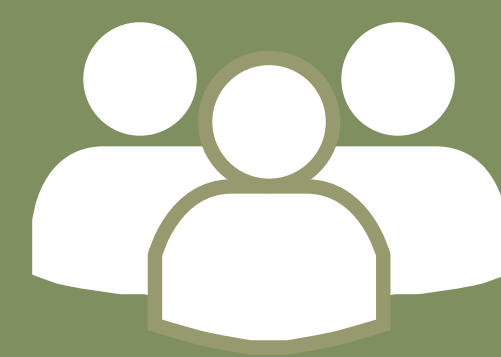

1 in 4[^]
RESPONSES

Related to a desire to improve Cribb Street

^Community engagement feedback received in Jan-Feb 2018

Potential ways the Cribb Street Streetscape Project, once delivered, can support the draft vision by:



A beautiful & defined town core

- Providing definition to the town centre by reinforcing Cribb Street as the main street
- Enhancing the appearance of the street through upgrading and beautification of the streetscape through landscaping and public art
- Providing community spaces by enabling the closure of Cribb Street for community events such as markets and street festivals
- Creating more enjoyable places to sit and enjoy the street
- Creating focus points and landscaping features



A place for people

- Strengthening and improving key links and permeability of Cribb Street
- Improving pedestrian environment with traffic slowing and raised crossings
- Providing functional and atmospheric lighting elements to support a place that is safe and inviting at night
- Improving the hard and soft landscape features along the street
- Installing street furniture such as seating, drinking bubblers and rubbish bins
- Providing parking in convenient locations to support access to local businesses



An authentic character & identity

- Developing a materials palette that is unique to Landsborough and has links to the Glass House Country region
- Designing a streetscape that is appropriate in scale and form for the town's identity
- Procuring public art elements such as sculpture, sound installations, lighting effects or interpretive heritage elements that are in-keeping with the character of Landsborough
- Designing street furniture that can be a point of interest and uniquely Landsborough



A reason to visit & stay

- Creating spaces for outdoor dining
- Designing the streetscape so Cribb street can be closed for events and pop-ups including markets and food trucks and other community events without effecting other streets
- Developing or enhancing points of interest along that street encourage exploration
- Investigating opportunities for activation and beautification of Laneways off Cribb Street
- Provide wayfinding to make it easier to explore the town

Cribb Street Streetscape Project

What we can do now in Landsborough...

Some ideas we have so far....

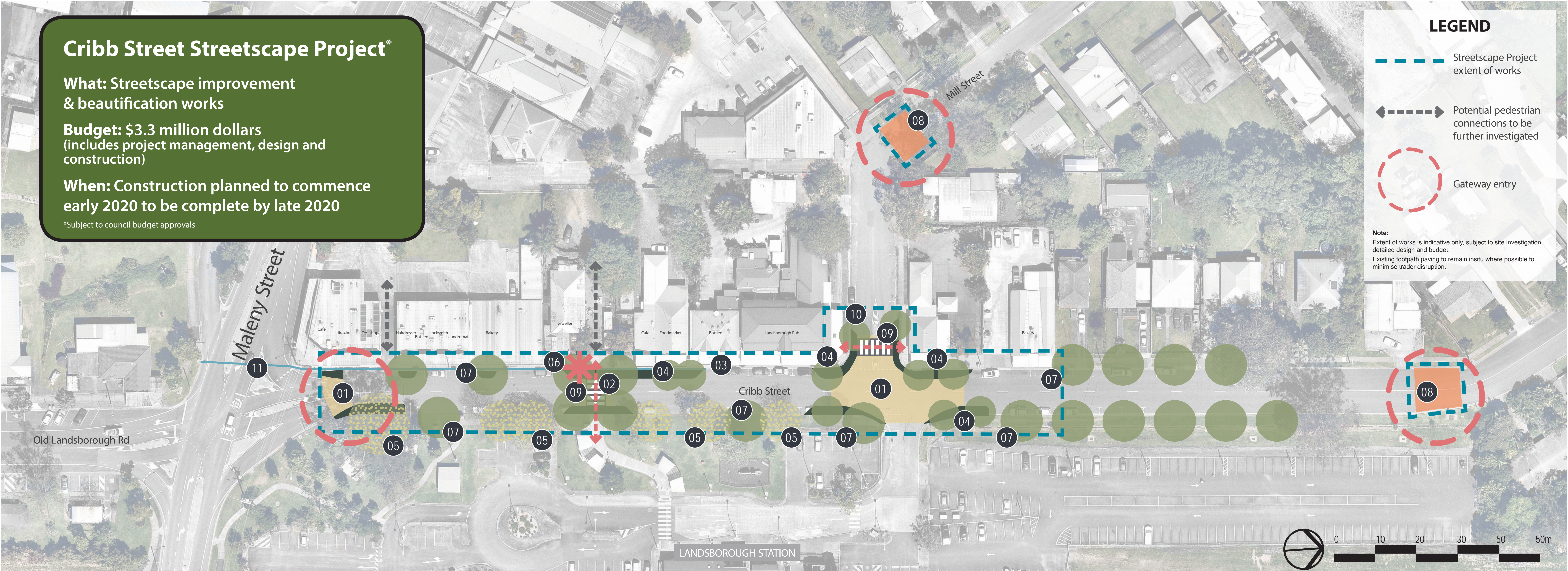

- 01 Road threshold treatment**
Painted road threshold treatment to demarcate town centre encouraging safer, slower driving behaviour.

02 Central pedestrian crossing area
Garden beds and tree planting at raised pedestrian crossing, reducing crossing length, reducing street scale & providing shade and amenity.
- 03 Existing paved footpath**
Existing paved footpath to be retained.

04 Footpath widening
Kerb build outs with garden beds, trees and pavement to facilitate wider footpath with potential for outdoor dining.
- 05 Bud lighting to existing trees**
Bud lighting to existing street trees eastern side of Cribb Street.

06 Artwork
Opportunity for artwork statement at central crossing area
- 07 Street tree planting**
Additional street tree planting on Cribb Street.

08 Traffic calming
Traffic calming element encouraging safer, slower driving behaviour.
- 09 Raised pedestrian crossing**
Raised concrete pedestrian crossing with lighting.

10 Mill Street parking and landscape works
Additional car parking bays and landscaping.
- 11 Storm water drainage improvements**
Upgrade to existing storm water infrastructure subject to investigation

Cribb Street Streetscape Project

Your ideas for Cribb Street...

We want to hear your ideas to help us to refine key place elements for Cribb Street.

Have your say

Any other ideas?...

Please use the sticky notes provided

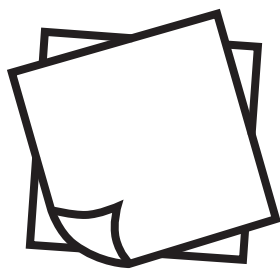

Place a sticker where you...



would like to cross the street



would like trees or garden features



would like to enjoy public art or interpretive elements



would like to sit or rest (chair or table)

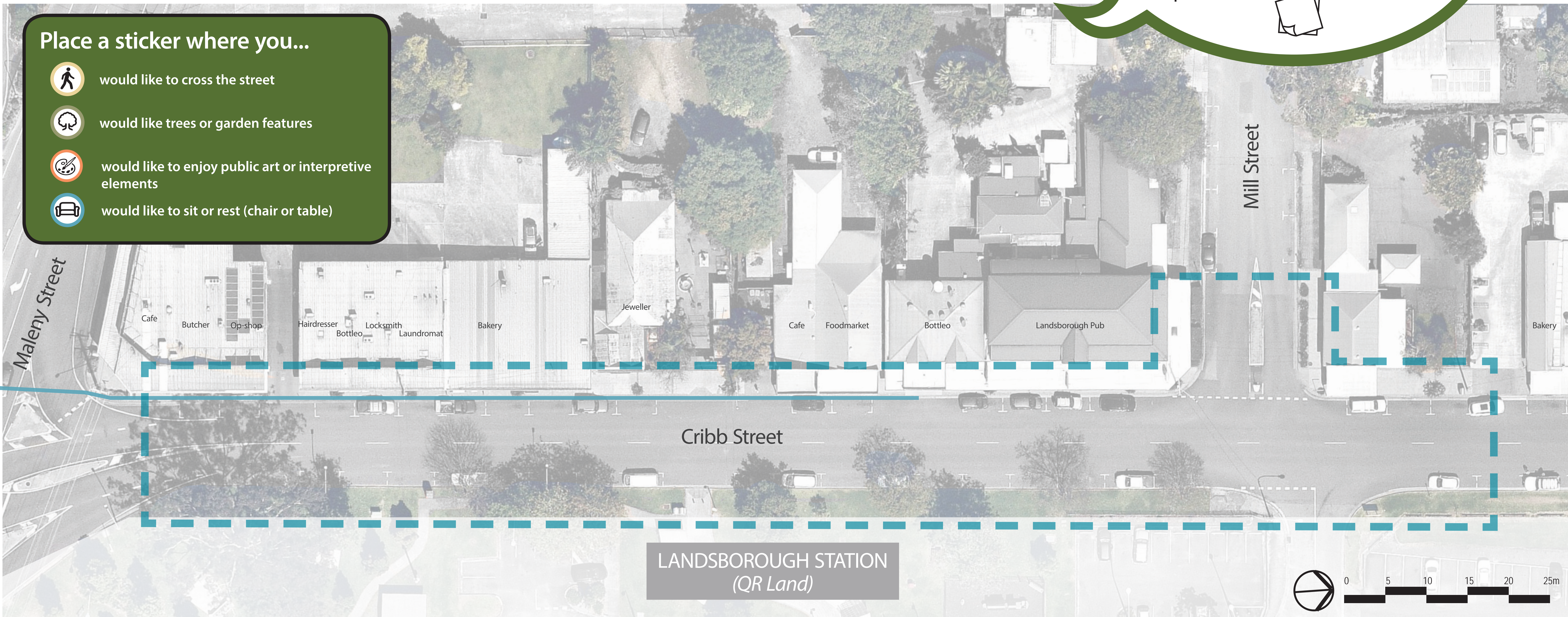

Considerations

- It is likely the storm water network will need upgrading in Cribb Street - there is an opportunity to include water sensitive urban design as part of the upgrade
- Bundling the overhead power lines is being considered to allow for bigger street trees
- In order to accommodate street tree planting on the shop side, a reconfiguration of car parking is being investigated with the aim of maintaining convenient car parking on Cribb Street and Mill Street
- The verge width on the eastern (railway) side is relatively narrow with well-established trees this will limit what can be constructed in this area
- Council is working with the current property owners to investigate closure of some of some driveways on Cribb Street to allow for activation opportunities and create a safer environment
- The majority of the park on the railway side of the street is State land managed by Queensland Rail which determines what can be changed in the area

Cribb Street Streetscape Project

Your ideas for Cribb Street...

Help us define the
‘look and feel’
for Cribb Street, and the kind of place
style and finishes that you would like
to see in the future...

Using the inspiration images, place dots on
those that best represent...



The look and feel you **WOULD LIKE**
TO SEE in the future in Cribb Street



The look and feel you would **NOT LIKE**
to see in the future in Cribb Street

Use sticker dots provided
(you do not have to use
all your dots)

Walls & pavements

Plants & trees

Furniture & seating



Timber texture



Local Glass House stone



Etched/ Patterned



Exposed concrete



Stone paving

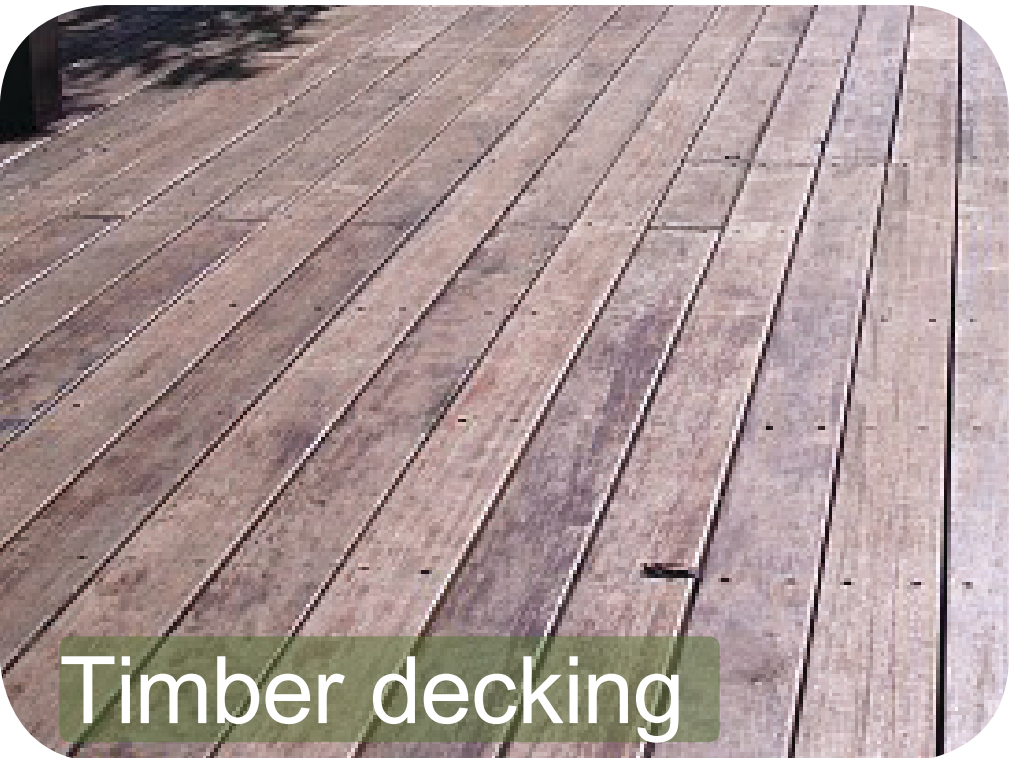

Timber decking



Clay pavers



Avenue tree planting



Cottage planting



Contemporary planting



Bird/insect attracting



Subtropical planting



Native bushland species



Curved timber & stone



Timber & stone



Heritage



Rustic



Integrated



Contemporary



Whimsical



Gabion seat wall



Standard



Weathered steel & timber

Have your say

Public art

Lighting

Innovations

Your suggestion

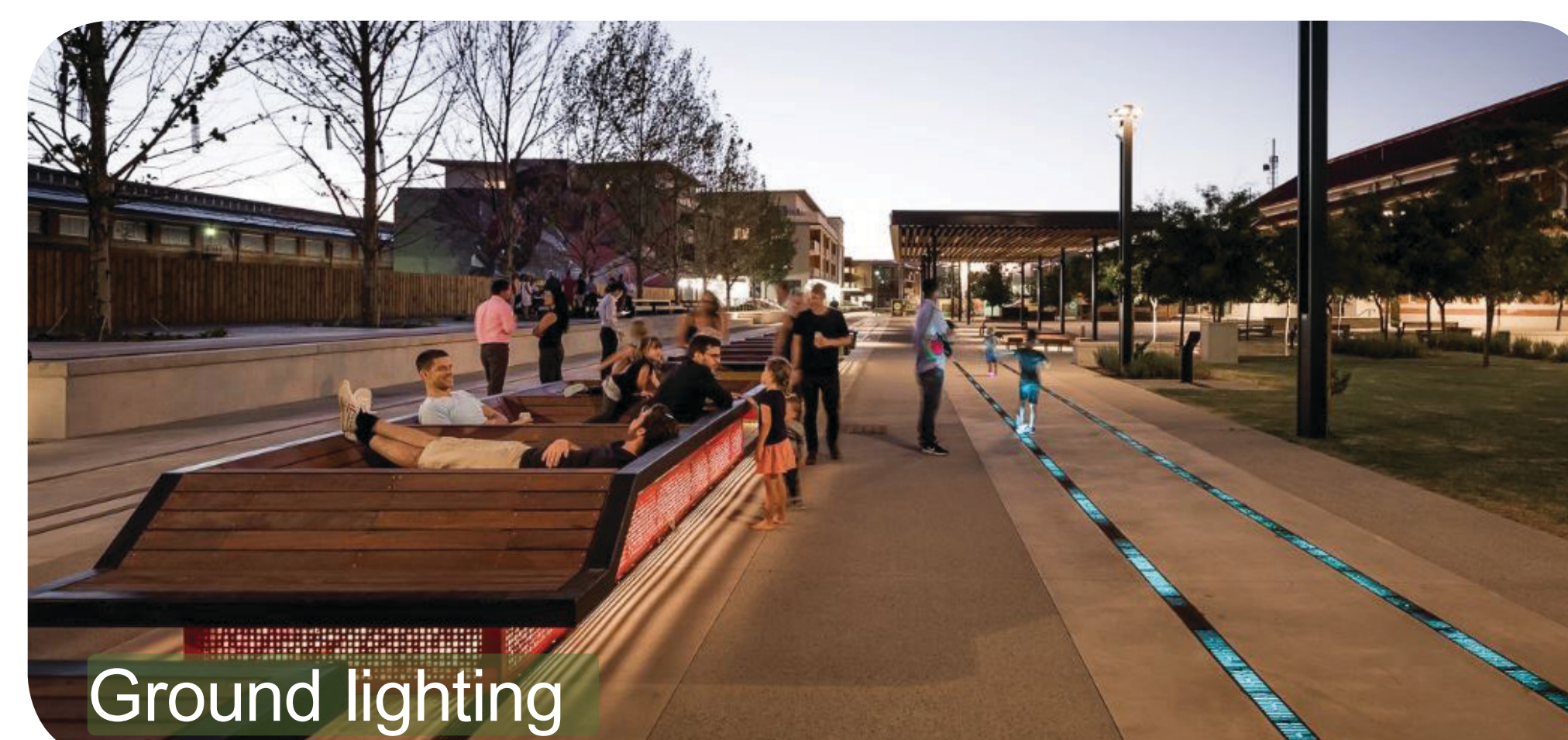
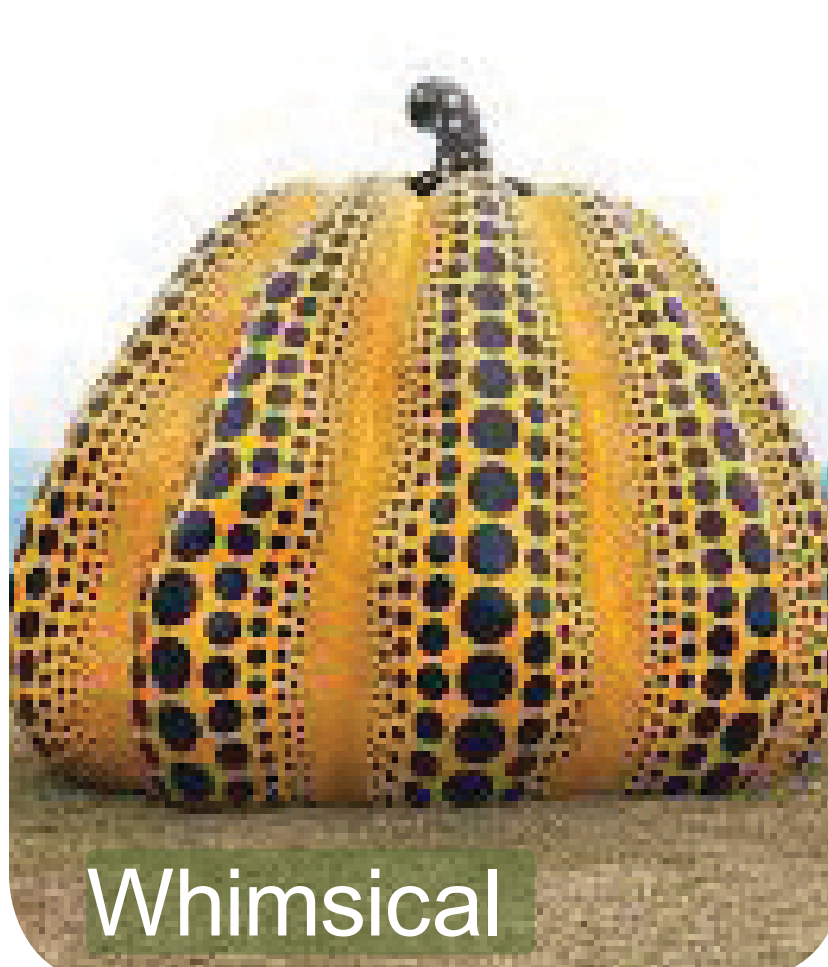

Any other ideas for the look and feel of Cribb Street?...
Please use the sticky notes provided



I would like to see...